

H.C.B-A8001

MULTI-FUNCTION PNEUMATIC/HYDRAULIC ENGINE LIFT

PAT.M 430377 PAT.M 443701 CE



VIDEO



- This is the best extracting tool for all kinds of transmission and engine. It can afford both weights of engine and transmission at the same time.
- Seven support frames on platform are adjustable depend on the size of transmissions or engines. It also increases the safety and stability.
- Four swivel caster wheels and pull rod design makes this equipment easy to move.
- Scissor structure.
- Power source: Dual-use design-hydraulic control and manual control.
- Stroke: 1250 mm
- Min height: 370 mm
- Max heightL 1650m
- Capacity: 1.5 tons
- Table size: 1040x800 mm

Instruction:

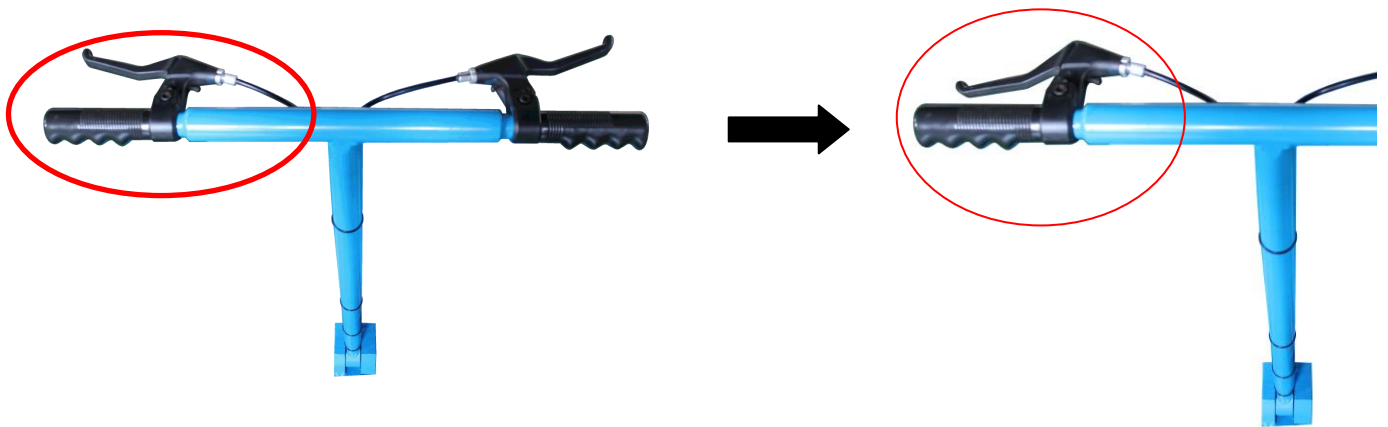

The left brake control safety device can be separated by pressing down. Please press it to the end to release. Under normal conditions, it is in close contact state (as shown below)

When the machine needs to be descend, the left brake must be pressed. Otherwise, the safety device will be lowered when the left brake is lowered.

Automatic stop and fall inversion can not press the left brake, need to rise a little longer to lift the safety device, press the left brake to lower the machine.

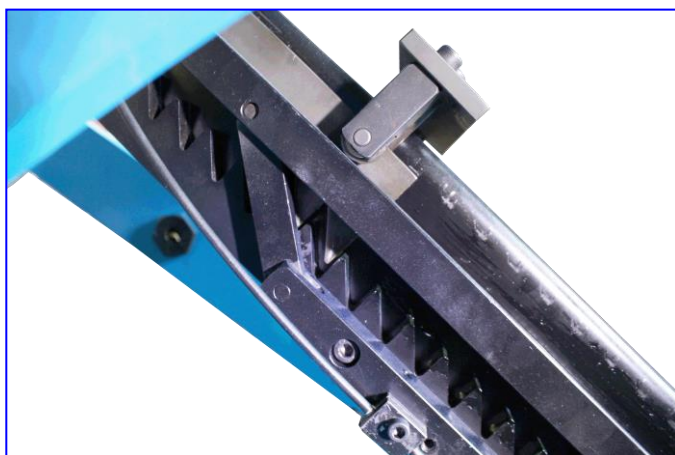
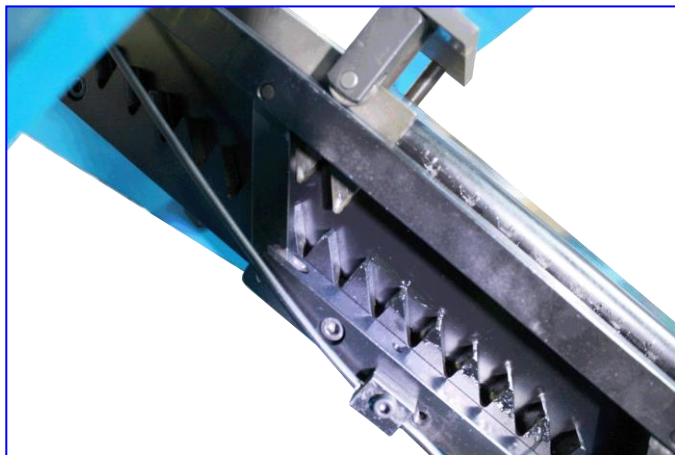



The right brake controls the angle of the rod. When the pressure is pressed, the machine can be adjusted at an appropriate angle (as shown below).

The circle parts is for optional accessory.

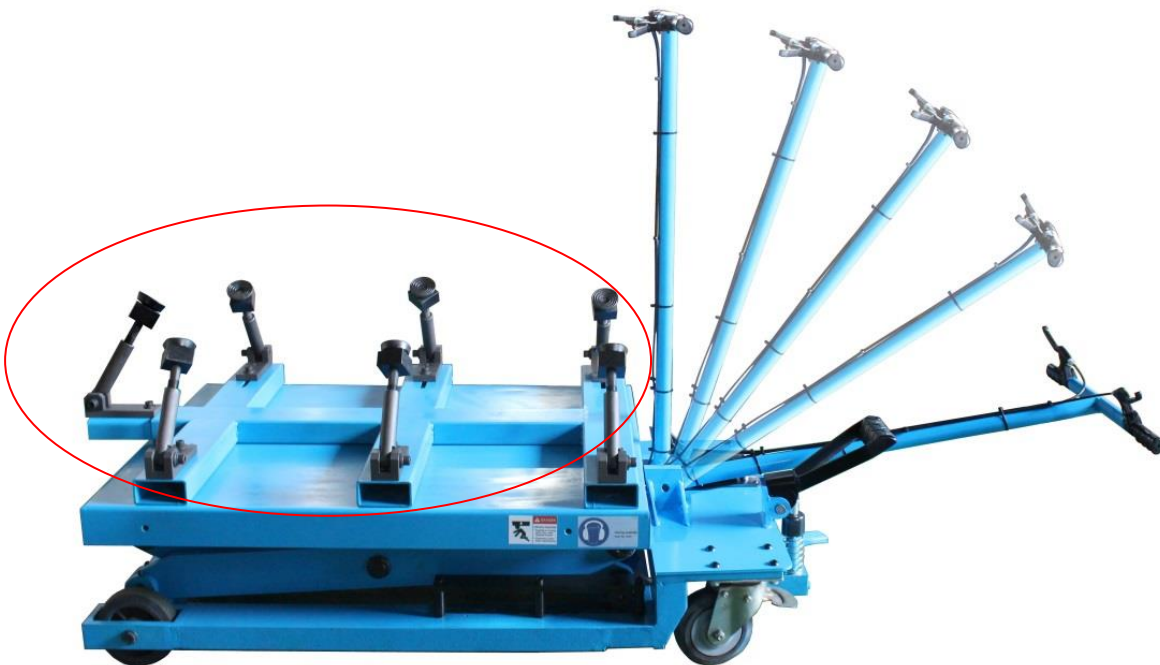

There are two ways to raise the machine:

1)By manual foot or 2)By pneumatic pump operation.

When the machine is lowered, the part of the artificial foot should be lightly stepped on and then the machine will slowly descend. If the pedal is too hard, the machine will fall quickly and cause danger. For the pneumatic part, please be careful not to exceed the range of the pump pedal to avoid being crushed by the lowered machine.

1)By manual foot

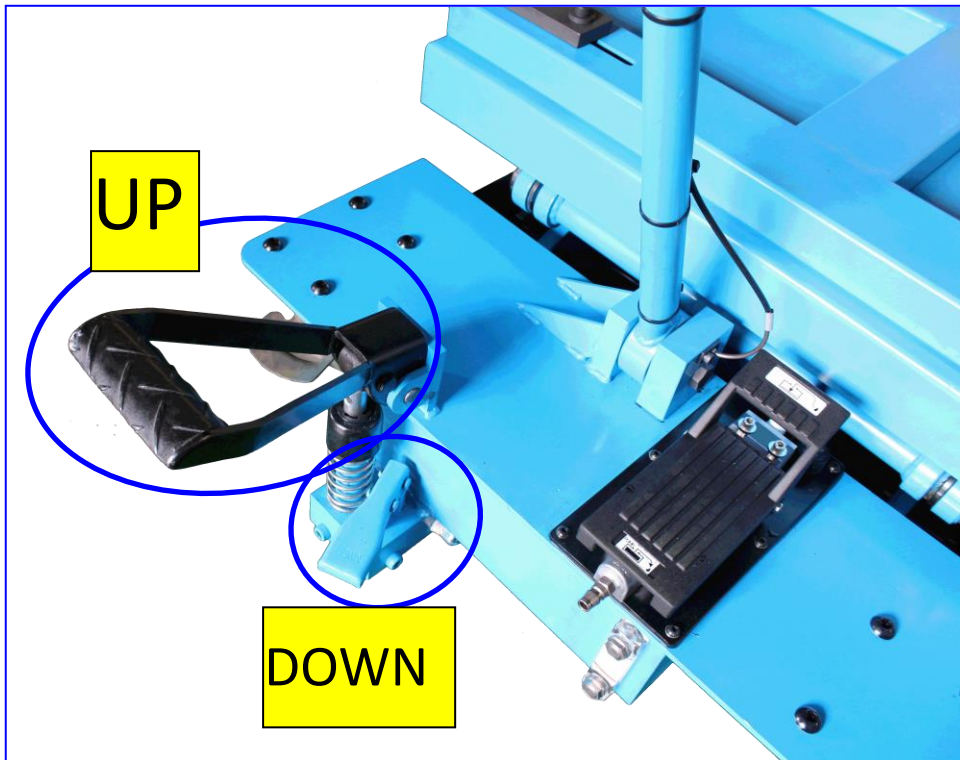

2)By pneumatic pump operation.



※ Please set air pressure between 5~8 KG/cm².